

Waste water systems

Accessories for waste water tanks

Waste water pump - EMP140

High-capacity diaphragm pump with rotatable connectors

The EMP140 is a robust and quiet diaphragm pump designed for waste water (black water and grey water) applications. It features rotatable hose connectors, which greatly reduce installation time and offer flexibility in tight spaces. The pump is self-priming and fitted with internal duck-bill valves for reliable non-return flow control.

Specifications

- Self-priming diaphragm pump with internal duck-bill valves
- Capacity: 27 L/min
- Rotatable hose connectors (38 mm) for easy installation
- Quiet operation and low maintenance

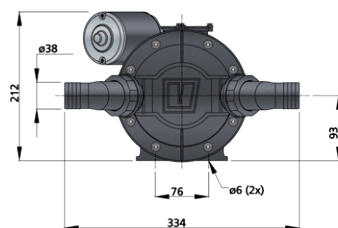
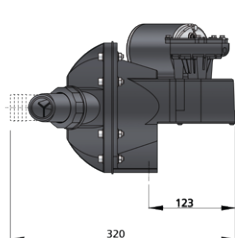

EMP140

Type	Voltage (VDC)	Current (A)	Connection (mm)	Weight (kg)	Capacity, at 0 m head (L/min)	Max. suction height (m)	Max. head (m)
EMP14012B	12	6	Angled, rotating Ø38	7	27	3	5
EMP14024B	24	4	Angled, rotating Ø38	7	27	3	5

General purpose self-priming pump - EIP12

Compact utility pump for bilge or deck wash

The EIP12 is a lightweight and compact self-priming electric pump designed for general use on board, such as bilge pumping or deck washing.

Specifications

- Self-priming
- Compact design
- 12 V DC only

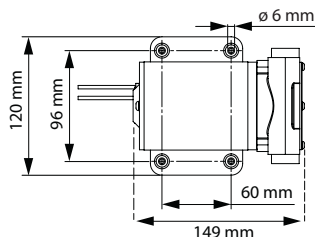

EIP12

Type	Suitable for	Voltage (DC)	Max pressure (bar)	Capacity (L/min)	Suction head (m)	Connection type	Weight (kg)
EIP12	Bilge water / deck wash	12	1	30	1	G1/2 internal thread	2,48