

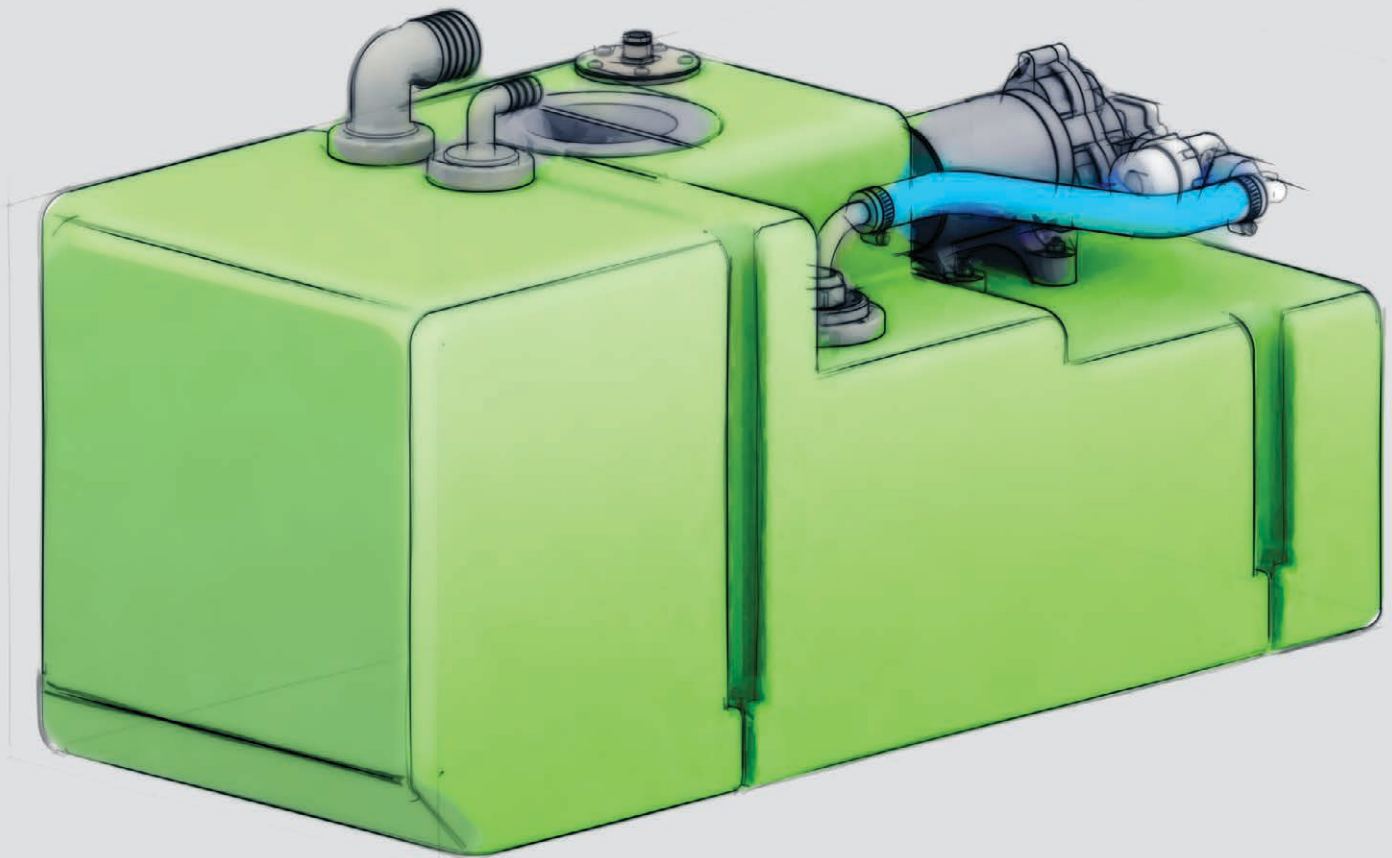

vetus

Fresh water systems



Fresh water systems

Overview

Rigid tanks see page 177 - 180



APT



WTANKC

DWSC

Flexible tanks see page 181



TANKW

Water heaters see page 182 - 183



WHT



WHD

Pressurized water systems

see page 184



PFWS..08



PFWS..19



Pressurized water system pumps

see page 185



WP

Accumulator tank

see page 185



EXPAT075

Accessories see page 186 - 189



DWHOSEB



HWHOSE



WTK02



WTIKIT



SENSOR



SENSORA
SENSORB



WTKIT



ILT120



ILTCOND

Accessories for hot water systems see page 190



WTS44513B



WHEL



WHMIXER



Fresh water systems

Fresh water systems - Safe, efficient, and easy to install

Clean fresh water is essential on board, whether you're cruising for a weekend or living aboard long-term. VETUS offers a complete and modular fresh water system that ensures long-lasting water quality, quiet operation, and simple installation. From tanks and heaters to pumps and accessories, every component is engineered for marine use and ease of maintenance.

Why choose a VETUS fresh water system?

- Wide variety of tanks: Our tanks are available in both rigid and flexible designs, made from high-quality materials that resist contamination and odours
- Easy access for cleaning: Large inspection covers make tank maintenance straightforward
- Durable design: Rigid tank with wall thickness of 5 to 8 mm to withstand onboard conditions
- Complete systems: Choose from a range of pressure systems with integrated pumps
- Electronic components are available in multiple voltage options
- Wide capacity range: Rigid and flexible tanks available in various sizes
- Corrosion-resistant: High-quality polyethylene materials avoid the issues found with metal tanks, such as corrosion

Components of the VETUS fresh water system

Rigid tanks

Made from robust high-quality polyethylene materials and available in many shapes and capacities. Designed for durability and hygiene.

Ready-to-install tanks

Preassembled units that include an electric pump, inspection lid, level sensor, and hose connections.

Flexible tanks

Ideal for tight spaces or irregular areas, these tanks are lightweight and conform to their environment. Made with durable, multi-layered construction.

Water heaters

Efficient heating using either engine heat, electric elements or even the onboard heating system (WHT calorifiers). Our advanced designs heat water faster and maintain temperature longer.

Pressurised water systems

Ensure a consistent water flow similar to household plumbing, thanks to integrated pressure tanks with diaphragm systems and pumps.

Accessories

From high-quality hoses and level sensors to connection kits and inspection ports, VETUS provides all necessary components for a reliable and hygienic fresh water supply.

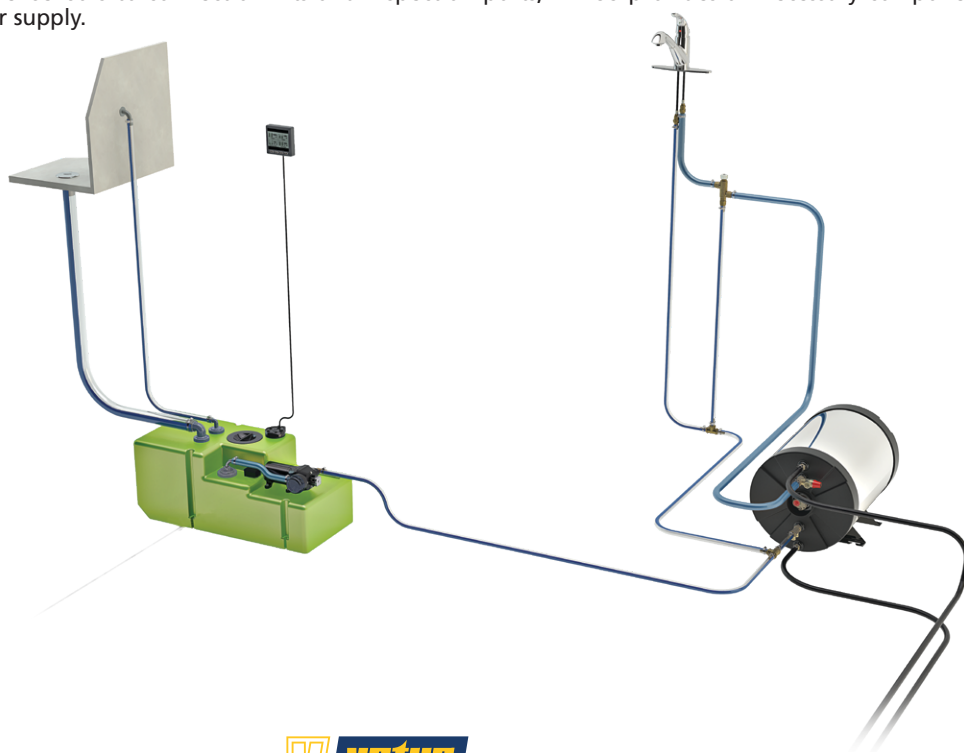



Rigid tanks for fresh water

ATANK series

Versatile and durable

The ATANK is a strong, multi-purpose tank designed to hold fresh water, waste water (both black and grey) or diesel fuel. It is made from thick high-quality polyethylene, which makes it more resistant to pressure. Unlike metal tanks, it does not corrode and produces less condensation. You can install an inspection lid and fittings wherever needed (sold separately). Labels for different contents like fresh water, are included.

Specifications

- Available in 42, 61, 88, 110, 137, 170, 215, 335 and 390 L
- Light blue translucent polyethylene
- Durable: Thick-walled construction
- Corrosion-resistant: Ideal for long-term use in tough environments
- Multi-purpose: Suitable for fresh water, waste water (black water and grey water) and diesel fuel
- Flexible installation: Fittings can be placed where needed

Some ATANK models include an integrated baffle that reduces liquid movement inside the tank during sailing. This improves stability and reduces noise.



ATANK

Type	Suitable for	Capacity (L)	Wall thickness (mm)	Baffle integrated	Colour
ATANK042	Fresh water (waste water or diesel)	42	5		Light blue translucent
ATANK061	Fresh water (waste water or diesel)	61	5		Light blue translucent
ATANK088	Fresh water (waste water or diesel)	88	6	✓	Light blue translucent
ATANK110	Fresh water (waste water or diesel)	110	6		Light blue translucent
ATANK137	Fresh water (waste water or diesel)	137	6	✓	Light blue translucent
ATANK170	Fresh water (waste water or diesel)	170	6,5	✓	Light blue translucent
ATANK215	Fresh water (waste water or diesel)	215	6,5	✓	Light blue translucent
ATANK335	Fresh water (waste water or diesel)	335	7	✓	Light blue translucent
ATANK390	Fresh water (waste water or diesel)	390	7	✓	Light blue translucent

Dimensions: plus or minus 2%

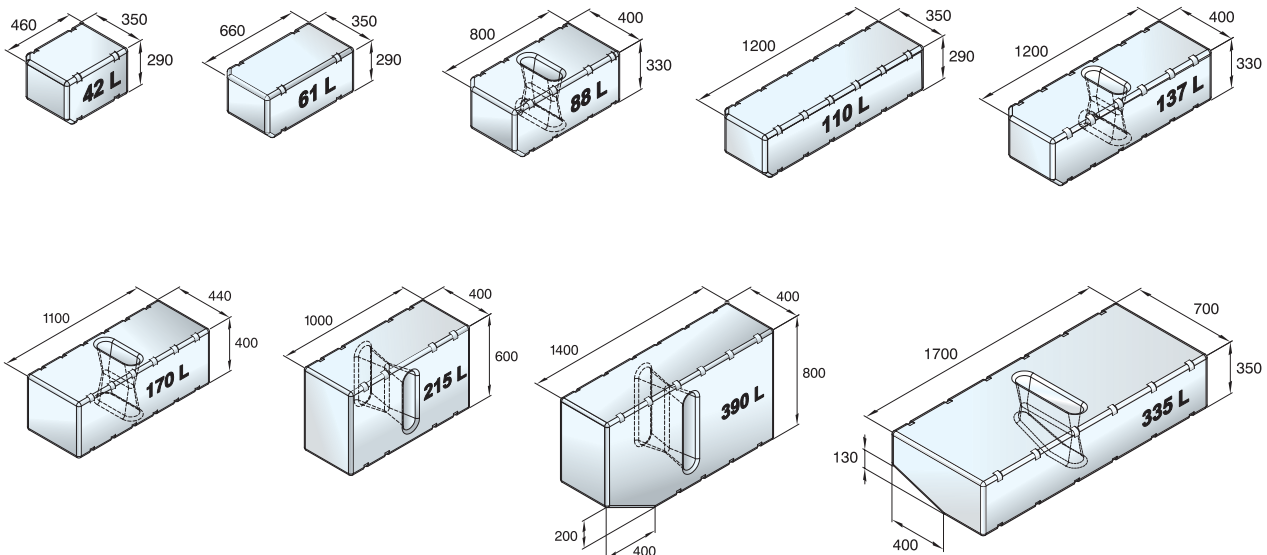

Fresh water systems

Rigid tanks for fresh water

Rigid all-purpose tanks for fresh water - APT series

Fresh water, waste water or diesel: this tank can handle it

The APT tanks are designed to store fresh water, waste water and diesel fuel. They are made from high-quality polyethylene with an antibacterial additive. All tanks come with a large inspection lid and are prepared for the ILTCOND connection kit. A 38 mm hose connection at the bottom can be drilled open for interconnection or drainage.

Specifications

- Available in 50, 75, 100, 150, 200, and 275 L
- Made from high-quality polyethylene with an antibacterial additive
- Suitable for fresh water, waste water or diesel fuel
- Large inspection lid (suitable diameter +/- 130 mm) to meet ISO 21487 (fuel tank standard)
- Ø 38 mm bottom hose connection (can be drilled open if needed) for interconnection purpose or draining
- Ready for ILTCOND connection kit
- Easy to clean and inspect thanks to a wide access lid
- Strong and durable for long-term marine use due to design and wall thickness
- Clear identification: Supplied with labels for all contents



Type	Tank capacity (L)	Tank pressure max. (bar)	Wall thickness (mm)	Connection (mm)	Colour
APT050	50	0,3	8	Ø 38 mm bottom outlet*, ILTCOND-ready	Light blue translucent
APT075	75	0,3	8	Ø 38 mm bottom outlet*, ILTCOND-ready	Light blue translucent
APT100	100	0,3	8	Ø 38 mm bottom outlet*, ILTCOND-ready	Light blue translucent
APT150	150	0,3	8	Ø 38 mm bottom outlet*, ILTCOND-ready	Light blue translucent
APT200	200	0,3	8	Ø 38 mm bottom outlet*, ILTCOND-ready	Light blue translucent
APT275	275	0,3	8	Ø 38 mm bottom outlet*, ILTCOND-ready	Light blue translucent

* can be drilled open if needed.

Recommended accessory - VTSTRAP lashing straps & WRILT lid opener

For secure installation of your APT tank, we recommend adding the VTSTRAP lashing strap set. A set includes two straps, each measuring 3 m long and 25 mm wide.

For easy and hassle-free lid handling, we recommend the WRILT opener (see page 186).



ILTCOND (Fresh water)

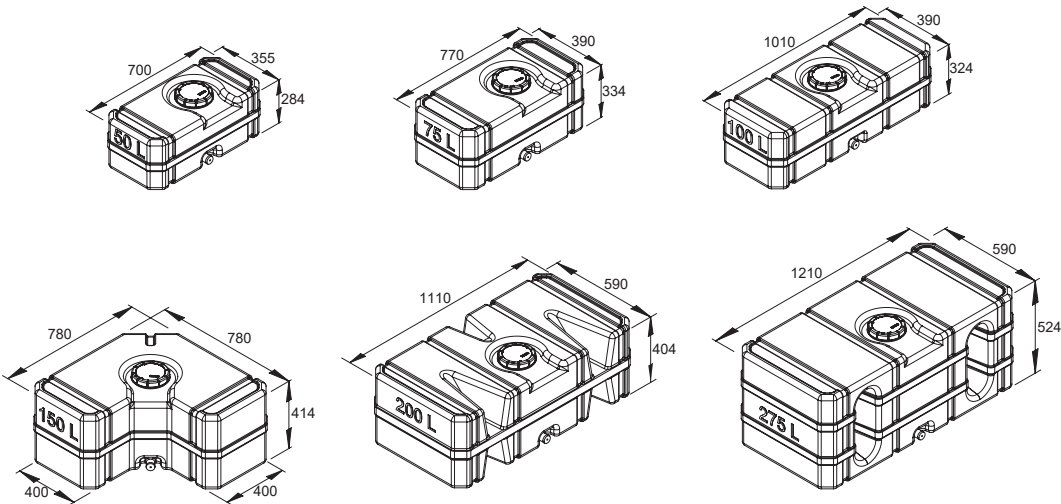



Rigid tanks for fresh water

WTANKC series

Quick to install with connectors included

The WTANKC tanks are designed to simplify installation and save time. They're made from green translucent high-quality polyethylene, so you can check the fluid level from the outside. All models come pre-formed with a blind hole standard SAE pattern for a level sensor (not included). Each tank includes connectors, inspection lid, and securing straps. All connections are made at the top to avoid leaks.

Specifications

- Available in 40, 60, and 80 L
- Translucent high-quality polyethylene
- Thick walled, 7 mm, resists pressure and deformation
- Quick setup: Connectors and securing straps included
- Easy installation level sensor: Blind holes SAE pattern pre-moulded



WTANKC

Type	Capacity (L)	Pressure max. (bar)	Connections Filling line (mm)	Connections Breather (mm)	Connections Pick-up pipe (mm)	SAE flange ready	Colour
WTANK40C	40	0,3	Fixed Ø 38	Fixed Ø 16	Rotating Ø 13	Yes	Green translucent
WTANK60C	60	0,3	Fixed Ø 38	Fixed Ø 16	Rotating Ø 13	Yes	Green translucent
WTANK80C	80	0,3	Fixed Ø 38	Fixed Ø 16	Rotating Ø 13	Yes	Green translucent

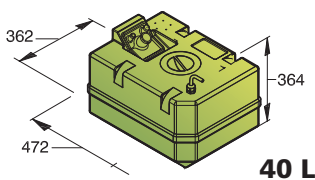

40 L

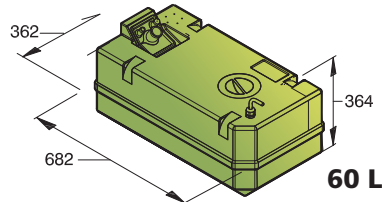

60 L

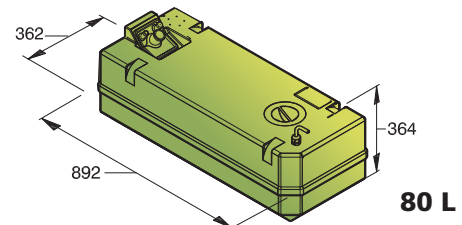

80 L

Height dimension includes connectors

Fresh water systems

Rigid tanks for fresh water

Fresh water system type DWSC

Comfort 'ready to go' system

This high grade synthetic tank for fresh water is supplied with an electric pump which automatically switches on when the pressure in the system drops (for example when a tap is opened).

Specifications

- Tank capacity of 42, 61, 88 and 120 L
- Wall thickness 6,5 mm
- System is available for 12 or 24 VDC
- Pump capacity 13.2 L/min. at zero head
- Connections for filling line Ø 38 mm, outlet line Ø 13 mm and ventilation line Ø 16 mm
- Also supplied with inspection cover, gauge sender, connectors and filter in suction line

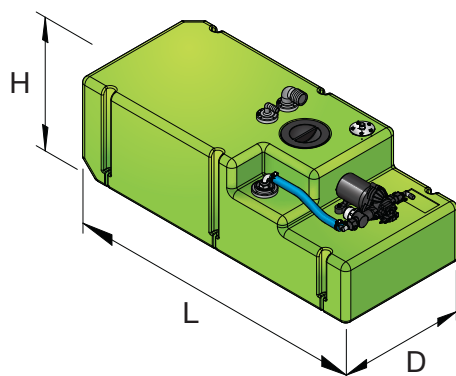

Type	Tank capacity (L)	Voltage (DC)	Ø Filler connection (mm)	Ø Breather connection (mm)	Ø Outlet connection (mm)	Pump capacity (L/min)	Pump pressure (Bar)	L Length (mm)	D Depth (mm)	H Height (mm)
DWSC04212	42	12	38	16	13	13,2	3,1	610	350	400
DWSC04224	42	24	38	16	13	13,2	3,1	610	350	400
DWSC06112	61	12	38	16	13	13,2	3,1	780	350	400
DWSC06124	61	24	38	16	13	13,2	3,1	780	350	400
DWSC08812	88	12	38	16	13	13,2	3,1	930	400	400
DWSC08824	88	24	38	16	13	13,2	3,1	930	400	400
DWSC12012	120	12	38	16	13	13,2	3,1	1050	450	400
DWSC12024	120	24	38	16	13	13,2	3,1	1050	450	400



Flexible tanks for fresh water

Type TANKW

Easy installation

These tanks are light weight and can be installed easily and quickly; they assume the shape of the space in which they are placed. Often, they can be used in awkward spaces or in locations which are difficult to reach. All fittings are supplied as standard. Fitting the outlet nipple and connecting the inlet and outlet hoses are the only things that need to be done.

Standard supplied with

- One angled connector for filling pipe Ø 38 mm (is fitted to the top of the tank)
- One angled connector for the pump hose Ø 16 mm (loose)

Additional nipples can be supplied as an option.



The VETUS flexible water tanks consists of three layers

1. A wear resistant layer
2. A reinforcement layer
3. A layer suitable for contact with fresh water

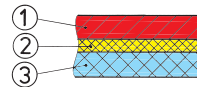

A repair kit is available (REPSETWT).

Type	Capacity (appr.) (L)	Dimensions (appr.) (mm)	Height filled (appr.) (mm)
TANKW55	55	680 x 780	250
TANKW70	70	780 x 780	270
TANKW100	100	790 x 1000	270
TANKW160	160	790 x 1420	270
TANKW220	220	740 x 2040	270
TANKW1003	100 (Δ)	1170 x 1490	240

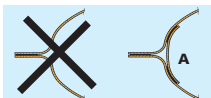
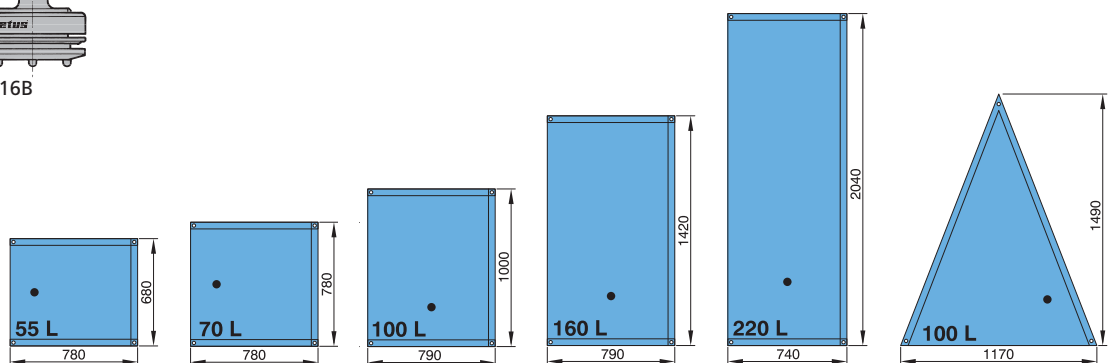
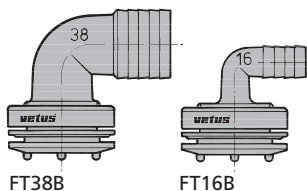

We not only weld the seams, but in addition we also weld an extra strip (see drawing A). This makes the VETUS flexible tank resistant against much higher pressures, especially if the contents are moving when the boat is rolling or pitching.

Fresh water systems

Water heaters

Standard twin coil water heater type WHT

This twin coiled calorifier range will double your comfort on board when it comes to hot water. One heating coil can be connected to the engine cooling circuit to make use of surplus engine heat. The other coil can be connected to an on board heating system. All water heaters are supplied with a 1500 Watt electric heating element, six hose connectors 16 mm and a 6 bar pressure relief/non return valve.

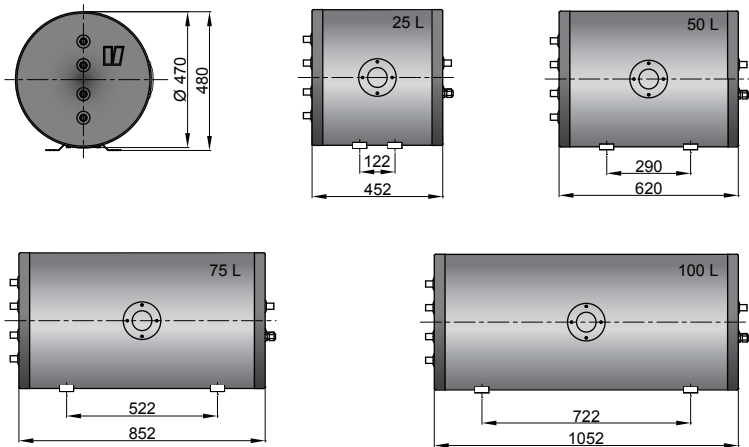

Type	Contents of fresh water (L)	Contents of coolant (L)
WHT025	25	0,5
WHT050	50	0,5
WHT075	75	0,5
WHT100	100	0,5

Specifications WHT

Construction	
Tank	Duplex stainless steel
Insulation	Polyurethane foam, 50 mm thickness, supplied with white coated steel outer jacket
Connections	
Engine coolant	G 1/2
On-board heating system	G 1/2
Fresh water	G 1/2
Heating element	G 1 1/4, 1500 Watt, 230 VDC
Pressure relief valve setting	6 bar (87 lbs / sq.inch)

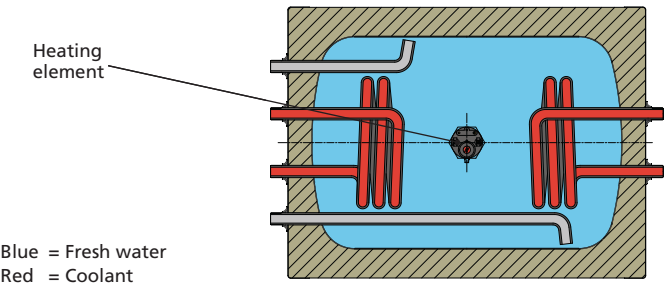



Water heaters

Premium double wall water heater type WHD

While conventional water heaters use a spiral tube to heat the water, these water heaters use a very efficient double wall principle. Thanks to this double wall principle, the VETUS double wall calorifiers have a heating surface, which is much greater than that of a conventional heating spiral tube. This means that the double walled water heaters will heat the water significantly faster than conventional calorifiers. All calorifiers are supplied with a 1500 Watt electric heating element, 4 x 16 mm hose connectors and a 6 bar pressure relief/non return valve.



WHD

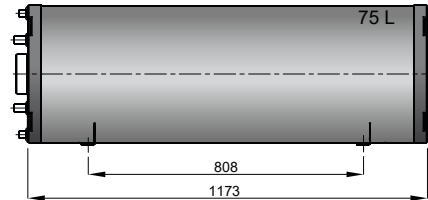
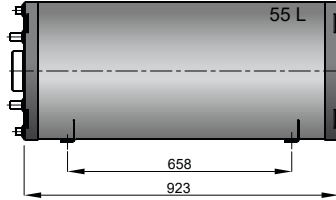
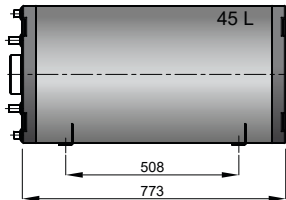
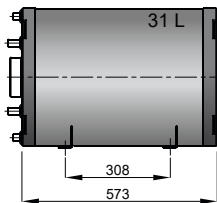
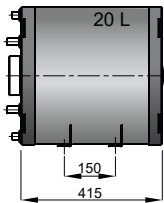
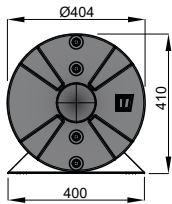

Type	Contents of fresh water (L)	Contents of coolant (L)
WHD020	20	2
WHD031	31	3
WHD045	45	5
WHD055	55	7
WHD075	75	9

Specifications WHD

Construction

Inner + outer tank	Stainless steel AISI 316L
Insulation	Polyurethane foam, 35 mm thickness, supplied with high gloss finished stainless steel outer jacket

Connections

Engine coolant	G 1/2
Fresh water	G 1/2
Heating element	G 1 1/4, 1500 Watt, 230 VDC
Pressure relief valve setting	6 bar (87 lbs / sq.inch)

Heating element

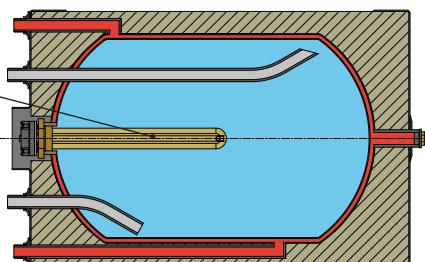

Blue = Fresh water
Red = Engine coolant

Fresh water systems

Pressurized water systems

Pressurized water system type PFWS

Ensuring constant water flow

This PFWS pressurized water system provides a constant flow in the fresh water circuit of the boat. It is comparable with a piped water system at home. The pressurized tank with a rubber diaphragm inside, prevents the pump motor being started each time a supply of water is required. The diaphragm is suitable for fresh water and can be replaced. This system ensures a constant water flow, saving of energy and minimum noise.

PFWS systems have an adjustable pressure switch, a manometer (pressure gauge) and a non-return valve. All VETUS pressurized water systems meet the EMC requirements.



PFWS..08



PFWS..19

Water system	Type PFWS1208 - PFWS2408	Type PFWS1219 - PFWS2419
Contents of pressure tank	8 L	19 L
Available in	12 VDC (7 A) 24 VDC (4 A)	12 VDC (15 A) 24 VDC (8 A)
Connection for hose	Ø 13 mm	Ø 19 mm
Weight	8,5 kg	9,5 kg
Capacity	13,2 L/min.	20 L/min.
Max. pressure	3,1 bar (45 psi)	4,2 bar (61 psi)
Max. suction height	1,8 m	1,8 m

Type PFWS..08

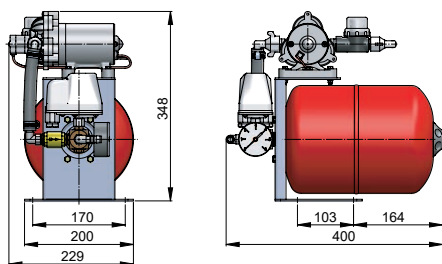

Type PFWS..19

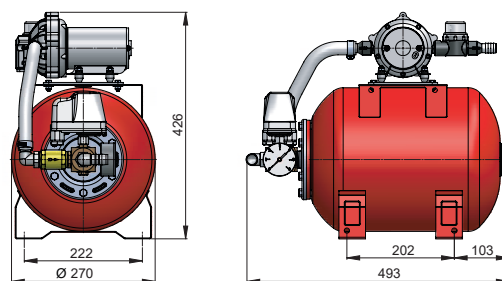



Pressurized water systems

Pressurized water system pump type WP

Silent running and smooth operation

These pumps are designed for pressurized water systems, washing, liquid transfer etc. Type WP is noiseless, low in energy consumption and can run dry without damage. It is well equipped with a thermal overload protection, built-in check valve and is auto demand with built-in pressure switch. This pump is supplied with two straight and two angled 13 mm hose connections, and inlet filter.

Type	Voltage (DC)	Flow (lpm)	Pressure (bar)	Max Current (A)	L x W x H (mm)
WP1208B	12	7,6	2,1	5	212 x 130 x 123
WP2408B	24	7,6	2,1	3	212 x 130 x 123
WP1213B	12	13,2	3,1	7	212 x 130 x 123
WP2413B	24	13,2	3,1	4	212 x 130 x 123
WP1220B	12	20	4,2	15	229 x 147 x 132
WP2420B	24	20	4,2	8	229 x 147 x 132



WP..08B

WP..13B



WP..20B

Accumulator tank type EXPAT075

Steady water pressure in the system

Made from high grade polyamide, this compact small capacity accumulator with rubber membrane provides a constant flow in the vessels water circuit. The pressure in the accumulator prevents the water pump motor being started each time a supply of water is required and the butyl rubber membrane is suitable for fresh water. Connecting is easy as there is no preferred IN or OUT connection on this accumulator.

The EXPAT075 ensures a constant water flow, saves energy and minimizes noise. The accumulator is set to a pre-charge pressure of 0,7 bar, but can be adjusted to optimal settings for your fresh water system (to a maximum of 8,5 bar). Overall dimensions are 223 mm x 194 mm x 114 mm and the accumulator is supplied with two angled and two straight 13 mm hose pillars.

Specifications

- Smooths water flow
- Extends the lifespan of your fresh water pump
- Tank is suitable for confined spaces
- Dampens pulsation in the system
- Volume: 0,75 L
- Temperature range: 0 to 50 °C
- Connections: ½" NPT Male
- Hose pillars: ½" NPT - ½" (13 mm) hose
- Weight: 0,36 kg



EXPAT075

Typ	Capacity (L)	Max. pressure (bar)	Connections	Dimensions L x W x H (mm)
EXPAT075	0,75	8,5	13 mm hose	223 x 194 x 114



Fresh water systems

Accessories

Hose type DWHOSEB

Temperature resistant between -5 and + 65 °C

This hose is made of transparent PVC with spiral inlay and is suitable for transportation of fresh water on board, both suction and pressure.



DWHOSEB

Type	Internal Ø (mm)	External Ø (mm)	Weight (kg/m)	Max. pressure (bar)	Bending radius (mm)	Roll length (m)	HCHDS clamp	HCS clamp
DWHOSE10B	10	16	0,16	7	20	30		HCS12
DWHOSE12B	12	18	0,18	7	25	30		HCS12
DWHOSE16B	16	22	0,24	6	35	30		HCS20
DWHOSE19B	19	26	0,32	5	50	30		HCS20
DWHOSE25B	25	33	0,53	5	60	30		HCS32
DWHOSE28B	28	36	0,57	4,5	66	30	HCHDS034	HCS32
DWHOSE30B	30	38	0,60	4,5	70	30	HCHDS037	HCS32
DWHOSE32B	32	40	0,56	4,5	75	30	HCHDS040	HCS40
DWHOSE35B	35	44	0,73	4	80	30	HCHDS043	HCS40
DWHOSE38B	38	47	0,80	4	90	30	HCHDS047	HCS40
DWHOSE40B	40	49	0,87	3	95	10	HCHDS047	HCS40
DWHOSE45B	45	55	1,10	3	105	10	HCHDS055	HCS50
DWHOSE50B	50	60	1,20	3	125	10	HCHDS059	HCS50

Hose type HWHOSE

Ideal for use with calorifier and hot water systems

Type HWHOSE is made of EPDM rubber with an inlay of woven synthetic fabric. This hose is suitable for fresh water and is temperature resistant between -30 and + 160 °C.



HWHOSE

Type	Internal Ø (mm)	External Ø (mm)	Weight (kg/m)	Max. pressure (bar)	Bending radius (mm)	Roll length (m)	HCS clamp
HWHOSE13	13	23	0,36	8	95	10	HCS20
HWHOSE16	16	26	0,40	8	110	10	HCS25

For a complete overview of our range of hoses see page 466. HCHDS (heavy duty) and HCS clamps are made of stainless steel AISI 316. For a complete overview of our range of hose clamps see page 440.

VSAW159 - Ø 159 mm hole saw

- Hole saw for creating the perfect tank opening
- Suitable for synthetic, G.R.P., or metal tanks
- Highly recommended for accurate installation of the ILT120 serie

WRILT - ILT lid opener

- Ergonomic tool to easily open and close ILT120.. lids
- Easy opening and ensures tight resealing

Type	Description
VSAW159	Ø 159 mm hole saw
WRILT	Lid opener tool for ILT120 series



VSAW159



WRILT



Accessories

Universal inspection port for fresh water tanks ILT120PL / ILT120PH

Easy access for cleaning and inspection

These innovative VETUS inspection ports are designed for easy access to your fresh water tank. With a reliable clamp-and-seal design, they ensure a watertight fit and can be installed on both thin- and thick-walled tanks. The ILT120PL is suitable for tank walls up to 4 mm. The ILT120PH handles wall thicknesses from 4 to 10 mm, ideal for VETUS ATANK models. Both versions feature a modular design, allowing additional connection kits (such as ILTCOND) to be added for a complete fresh water system upgrade.

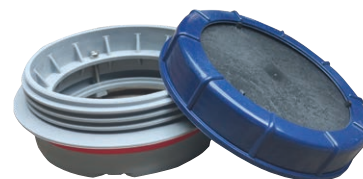

ILT120

Specifications

- Universal inspection port for fresh water tanks
- Watertight "clamp and seal" design using silicone gasket
- Suitable for synthetic, G.R.P., or metal tanks
- Quick and simple installation using the VETUS hole saw (VSAW159)
- Compatible with ILTCOND connection kit for tank upgrades
- Robust construction with counter flange and five-bolt locking system

Specification	ILT120PL	ILT120PH
Suitable wall thickness	0,8 - 4 mm	4 - 10 mm
Suitable diameter	120 mm	120 mm
Required hole diameter	159 mm	159 mm
Material	Synthetic, corrosion-proof	Synthetic, corrosion-proof
Compatible with ILTCOND	Yes	Yes
Application	Fresh water, waste water tanks	Fresh water, waste water tanks

ILTCOND - Fresh water connection kit

All-in-one upgrade for your tank inspection port

The VETUS ILTCOND is a complete fresh water connection kit that transforms your ILT inspection port (ILT120PL or ILT120PH) into a fully functional connection hub.

Specifications

- Turns ILT120 inspection ports into a full connection hub
- Includes:
 - Ø 38 mm fresh water fill connection.
 - Ø 13 mm fresh water suction connection
 - Ø 16 mm ventilation connection
- SAE 5-hole pattern for level sensor
- Made from corrosion-resistant materials
- Optional a 38 mm connection elbow 90 degrees (ILTCON90) is available

Specification	ILTCOND
Compatible with	ILT120PL / ILT120PH
Application	Fresh water tanks



ILTCOND

ILTCON90 - 90° elbow adapter

- 90-degree Ø 38 mm connection for ILTCONW
- Ideal for tight spaces

Type	Description
ILTCON90	Ø 38 mm elbow for ILTCOND



ILTCON90



Fresh water systems

Accessories

Inspection lid type WTK02

For (waste) water tanks only!

Without counter flange.

Specifications

- Overall diameter Ø 156 mm
- Cut out diameter Ø 115 mm
- Not suitable for fuel tanks
- Ideal for metal tanks



WTK02

Type	Description
WTK02	Inspection lid only, for rigid fresh water tanks
ILT120PL / ILT120PH	See page 187 for inspection port ILT120PL / ILT120PH

Inspection lid kit type WTIKIT

Complete with gasket, counter flange and fastenings

Specifications

- Overall diameter Ø 156 mm
- Cut out diameter Ø 115 mm
- Not suitable for fuel tanks



WTIKIT

Type	Description
WTIKIT	Inspection lid for rigid fresh water tanks
ILT120PL / ILT120PH	See page 187 for inspection port ILT120PL / ILT120PH

Installation kit type WTKIT

With inspection lid and angled connectors

The installation kit consists of

1. One inspection lid (WTIKIT)
2. One right angle connector (RT38B) for filling hose Ø 38 mm
3. One right angle connector (RT16B) for water pump Ø 16 mm
4. One right angle connector (RT16B) for ventilation Ø 16 mm
5. Two lashing straps
6. T-piece for interconnecting two tanks Ø 16 mm

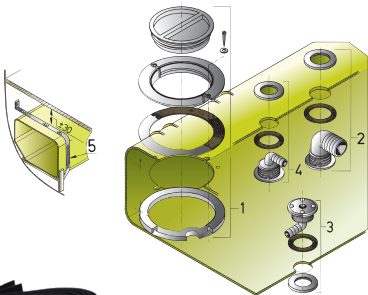

WTKIT

Type	Description
WTKIT	Installation kit for fresh water tanks



Accessories

Universal sender for fresh water, petrol/gasoline and diesel fuel

Universal tank sender for fresh water, petrol and diesel fuel (type SENSOR). Available in seven different lengths: 280, 320, 380, 480, 580, 680 or 780 mm. The VETUS universal tank sender indicates the difference in fluid level in steps of 2.5 cm. Just compare this with other systems which can only show three positions (full - about half full - empty).

Specifications

- Empty 300 Ω
- Full 10 Ω
- For 12 and 24 VDC

Type	Length (mm)	Voltage (DC)
SENSOR280	280	12/24
SENSOR320	320	12/24
SENSOR380	380	12/24
SENSOR480	480	12/24

Type	Length (mm)	Voltage (DC)
SENSOR580	580	12/24
SENSOR680	680	12/24
SENSOR780	780	12/24

SENSOR



Each tube length contains the maximum number of reed contacts (electronic switches), instead of the bare minimum of just three (full, half full, empty). Because of this, your tank gauges will read with maximum accuracy. The reed contacts are sealed "fluid-tight".

Ultrasonic level sensors

Accurate, contactless tank monitoring

The VETUS SENSORA and SENSORB are advanced ultrasonic level sensors designed to monitor tank contents without any moving parts or direct contact with the liquid. These sensors can be used in fresh water, waste water (black and grey water), diesel fuel, or petrol tanks of almost any shape and size - up to 120 cm deep. Max. tank capacity 5000 L. Perfect for modern boats and yachts, they offer easy installation and high reliability. Once installed, the sensor can be calibrated on the spot using a built-in LED and wire. No extra tools are needed.



SENSORA

SENSORB

Specifications

SENSORA - Analogue output sensor

- Contactless ultrasonic measurement for high reliability
- Compatible with all VETUS analogue tank level gauges and WWCP panel
- Easy onboard calibration with LED and a calibration wire
- Ideal for fresh water, black/grey water, diesel, or gasoline tanks
- Not suitable for use with metal tanks

Specifications

SENSORB - CANbus sensor

- Uses RS485 bus interface (CANbus type)
- Designed for integration with digital VETUS display SENSORD
- Contactless, reliable, and easy to calibrate
- Ideal for high-end digital installations
- Not suitable for use with metal tanks

By using an RS485 user interface, data can be transmitted over long distances without signal loss, there is a higher degree of noise immunity, and support for eight sensors connected to one SENSORD panel.

Feature	SENSORA	SENSORB
Output interface	Analogue	RS485 Bus (CANbus)
Voltage	12 / 24 VDC	12 / 24 VDC
Current consumption	35 mA	35 mA
Max. tank depth	120 cm	120 cm
Accuracy	±5%	±5%
Temperature range	-20 °C to +70 °C	-20 °C to +70 °C
Mounting flange	SAE, 5-hole	SAE, 5-hole
Dimensions	Ø 77 mm x 23 mm	Ø 77 mm x 23 mm
Compatibility	Analogue gauges, WWCP panel	SENSORD digital display
Suitable for	Water, black/grey water, fuel tanks	Fresh water, black/grey water, fuel tanks
Not suitable for	Metal tanks	Metal tanks

Fresh water systems

Accessories

Suction pipe type WTS44513B

Fitted to the top of fixed tanks

This suction pipe can be fitted to the top of most of the fixed tanks with a maximum depth of 410 mm and is suitable for Ø 13 mm fresh water systems.

Type	Description
WTS44513B	Suction pipe for fresh water tanks

WTS44513B



Accessories for water heaters

Heating element type WHEL

Adjustable thermostat (40 - 80°C). Male thread size, ISO 228/1 G1¼. Screw-in length of element is 300 mm.

Electric heating elements

- 500 Watt, 230 VAC
- 1000 Watt, 120 VAC
- 1000 Watt, 230 VAC
- 1500 Watt, 230 VAC

VETUS heating elements type WHEL meet the low voltage requirements.

Type	Voltage (AC)	Watt (W)
WHEL22500	230	500
WHEL220	230	1000
WHEL110	120	1000
WHEL1500	230	1500

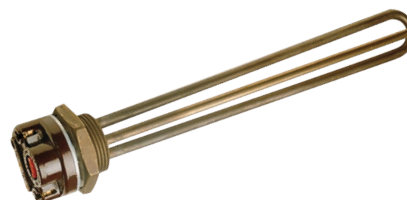

WHEL

Thermostatic mixer for water heaters

Water heaters which are heated by the engine coolant, can deliver their fresh water contents at temperatures of more than 90°C. There is always a risk that these high temperatures could cause scalding when washing or showering. Using a mixer tap can take too long to find a suitable temperature, with high water usage as a consequence.

By fitting a thermostatic mixer, the risk of scalding is eliminated and a safe and comfortable temperature for each requirement is easily selected. So, no more hot water wastage, a constant safe temperature at the tap and energy saving.

The thermostatic mixer is provided with G½ thread. The temperature is infinitely adjustable between 30° and 70°C.

Type	Description
WHMIXER	Thermostatic mixer for water heaters

WHMIXER

